

JISF7333 5K/10K CAST IRON HOSE GLOBE/ANGLE VALVE C/W NAKAJIMA COUPLING

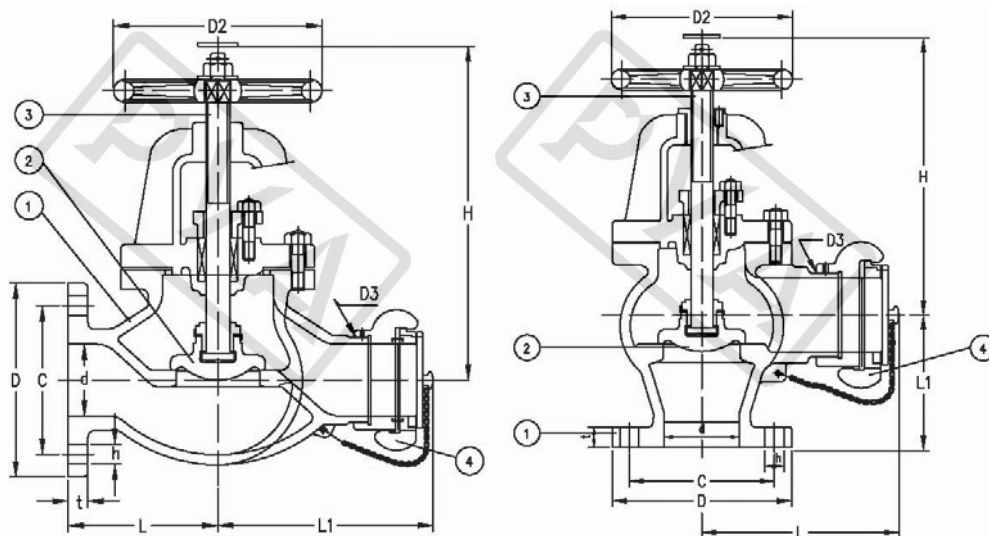

Globe/A Type

Angle/B Type

Pressure Test MPa			
Nominal Pressure/PN	0.5/1.0MPa	Shell Test	1.05/2.10MPa
		Seat Test	0.75/1.54MPa

Main material for fittings			
Item	Fittings	Material	Mark
1	Body	Cast Iron	FC200
2	Bonnet	Cast Iron	FC200
3	Disc/ Seat	Stainless Steel/Cast Bronze	SS420/BC6
4	Stem	Stainless Steel/Forged Brass	SS400/C3771BD
5	Handwheel	Cast iron	FC200

Main data for flange connection								mm
Model	Face To Face		F/Diam.	F/PCD	F/Hole	Height	Thread	Weight
	L1	L	D	C	n* Φ d	H	D3	kgs
F7333A 5K50	165	105	130	105	4 \times Φ 15	275	M64*2	14.70
F7333A 5K65	195	130	155	130	4 \times Φ 15	310	M80*2	21.20
F7333A 10K50	170	110	155	120	4 \times Φ 19	285	M64*2	18.90
F7333A 10K65	200	135	175	140	4 \times Φ 19	310	M80*2	28.20
F7333B 5K50	155	100	130	105	4 \times Φ 15	255	M64*2	12.80
F7333B 5K65	180	125	155	130	4 \times Φ 15	270	M80*2	16.70
F7333B 10K50	170	120	155	120	4 \times Φ 19	255	M64*2	17.00
F7333B 10K65	185	130	175	140	4 \times Φ 19	270	M80*2	24.30

Design	Check	Signature	Logo	Supplier
asbsey	Chrit	Figor		PROMET VALVES AUSTRALIA
JAN.01,2013	JAN.01,2013	JAN.01,2013		

PROMET VALVES AUSTRALIA

1A Green Road Woodville West SA 5011 Australia / Tel:+61 8 8268 1777 / Fax:+61 8 8268 1711
 promet@prometvalves.com / www.prometvalves.com / ABN 47 096 425 697