

## Flanschen-Absperrventil, GGG 40.3/Niro mit Bügeldeckel

**Stop valve, flanged, nodular cast iron/stainless steel  
with bolted bonnet**

Nennndruck / Nominal pressure PN16

**Art.Nr. 20.01.01** Form A Durchgangsform / straight type

**Art.Nr. 20.01.02** Form B Eckform / angle type

### Verwendungsbereich:

Geeignet für Dampf, Luft, Kalt- und Heißbrauchwasser, Öl (Heiz-, Treib- und Schmieröl), Gase und andere neutrale Flüssigkeiten.

Verwendbar für Temperaturen bis 350°C

### Zulässige Betriebstemperaturen und -drücke:

|           |             |
|-----------|-------------|
| bis 120°C | max. 16 bar |
| 200°C     | 15 bar      |
| 250°C     | 14 bar      |
| 300°C     | 13 bar      |
| 350°C     | 11 bar      |

### Sonderausführungen:

- ◇ Gehäuse und Deckel aus EN-GJL-250, GP240 GH
- ◇ Innenteile aus Bronze
- ◇ DN 15 – DN 200 PN 6, PN25, PN40  
DN 200 PN10
- ◇ Flansche nach ANSI, BS usw. auf Anfrage
- ◇ Regulierkegel
- ◇ Entlastungskegel
- ◇ Entwässerungsschraube
- ◇ Anzeigevorrichtung
- Wesentliche Vorteile:**
- ◇ hoher Dichtheitsgrad
- ◇ kompakte Bauweise
- ◇ wartungsfrei
- ◇ umweltfreundlich

### Application:

Suitable for steam, air, industrial cold and hot water, oil (fuel oil, diesel oil, lubricating oil), gases and other neutral fluids.

Application for temperatures up to 180°C

### Admissible temperatures and pressures:

|             |             |
|-------------|-------------|
| up to 120°C | max. 16 bar |
| 200°C       | 15 bar      |
| 250°C       | 14 bar      |
| 300°C       | 13 bar      |
| 350°C       | 11 bar      |

### Special design:

- ◇ body and bonnet material EN-GJL-250, GP240 GH
- ◇ innerparts material bronze
- ◇ DN 15 – DN 200 PN 6, PN25, PN40  
DN 200 PN10
- ◇ flanges acc. ANSI, BS etc. on request
- ◇ regulating disc
- ◇ balanced disc
- ◇ drain plug
- ◇ indicator
- Main advantages:**
- ◇ high tightness
- ◇ compact construction
- ◇ no maintenance
- ◇ environmentally friendly

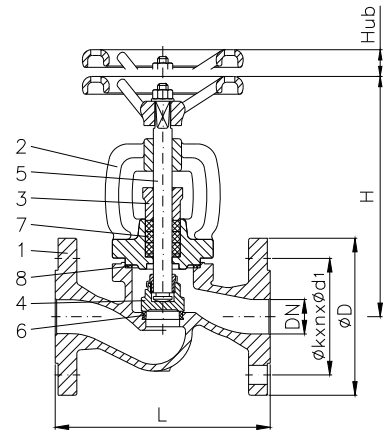

**Art.Nr. 20.01.01**

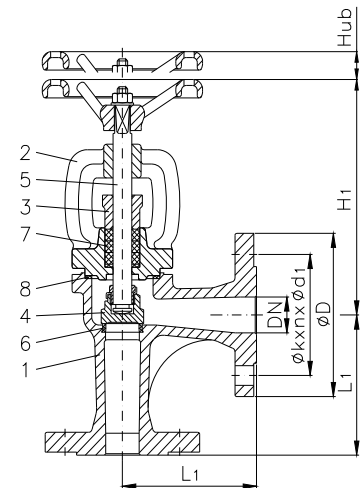

**Art.Nr. 20.01.02**

| Teil<br>Part | Bezeichnung<br>Name               | Werkstoff nach DIN/EN<br>Material acc. to DIN/EN          | Werkstoff nach USA<br>Material acc. to USA |
|--------------|-----------------------------------|---|--|
| 1            | Gehäuse / body                    | EN-GJS-400-18-LT  | ---  |
| 2            | Bügeldeckel / bonnet              | EN-GJS-400-18-LT  | ---  |
| 3            | Kegel / disc                      | DN 15 – DN 65 X20Cr 13<br>DN 80 – DN 200 EN-GJS-400-18-LT | 420 (AISI)                                 |
| 4            | Spindel / stem                    | X20Cr 13  | 420 (AISI)                                 |
| 5            | Sitzring / seat ring              | X5CrNi18-10   | 304 (AISI)                                 |
| 6            | Stopfbuchspackung / gland packing | Graphit   | ---  |
| 7            | Deckeldichtung / bonnet sealing   | Graphit   | ---  |

### Flansch / flange

| DN  | PN10 |                |  | PN16 |                |  | L   | L1  | H   | H1  | Form A | Form B |
|-----|------|----------------|--|------|----------------|--|-----|-----|-----|-----|--------|--------|
|     | Ø D  | Ø k x n x Ø d1 |  | Ø D  | Ø k x n x Ø d1 |  |     |     |     |     | ≈ kg   | ≈ kg   |
| 15  | 95   | 65 x 4 x 14    |  | 95   | 65 x 4 x 14    |  | 130 | 90  | 165 | 155 | 3,8    | 4,2    |
| 20  | 105  | 75 x 4 x 14    |  | 105  | 75 x 4 x 14    |  | 150 | 95  | 165 | 155 | 4,0    | 5,0    |
| 25  | 115  | 85 x 4 x 14    |  | 115  | 85 x 4 x 14    |  | 160 | 100 | 180 | 170 | 5,0    | 6,0    |
| 32  | 140  | 100 x 4 x 19   |  | 140  | 100 x 4 x 19   |  | 180 | 105 | 180 | 175 | 7,0    | 8,0    |
| 40  | 150  | 110 x 4 x 19   |  | 150  | 110 x 4 x 19   |  | 200 | 115 | 215 | 195 | 11,0   | 10,0   |
| 50  | 165  | 125 x 4 x 19   |  | 165  | 125 x 4 x 19   |  | 230 | 125 | 230 | 205 | 13,0   | 13,0   |
| 65  | 185  | 145 x 4 x 19   |  | 185  | 145 x 4 x 19   |  | 290 | 145 | 245 | 225 | 18,0   | 18,0   |
| 80  | 200  | 160 x 8 x 19   |  | 200  | 160 x 8 x 19   |  | 310 | 155 | 295 | 250 | 23,0   | 24,0   |
| 100 | 220  | 180 x 8 x 19   |  | 220  | 180 x 8 x 19   |  | 350 | 175 | 325 | 305 | 35,0   | 38,0   |
| 125 | 250  | 210 x 8 x 19   |  | 250  | 210 x 8 x 19   |  | 400 | 200 | 360 | 315 | 53,0   | 50,0   |
| 150 | 285  | 240 x 8 x 23   |  | 285  | 240 x 8 x 23   |  | 480 | 225 | 425 | 380 | 75,0   | 70,0   |
| 200 | 340  | 295 x 8 x 23   |  | 340  | 295 x 12 x 23  |  | 600 | 275 | 505 | 425 | 135,0  | 107,0  |