



Z412

BRONZE CHECK VALVE

Horizontal Lift Type - Bolted Cover - Replaceable Bronze Trim

An AS 2129 E flanged cast bronze horizontal lift check valve with bolted cover, straight pattern and replaceable bronze seat & disc.

PRESSURE/TEMPERATURE RATING

Steam up to 700KPA (100PSI)

Max Service Temp 170°C (338°F)

Water, Oil or Gas up to 1400KPA (200PSI)

OPTIONS

Modifications available upon request.

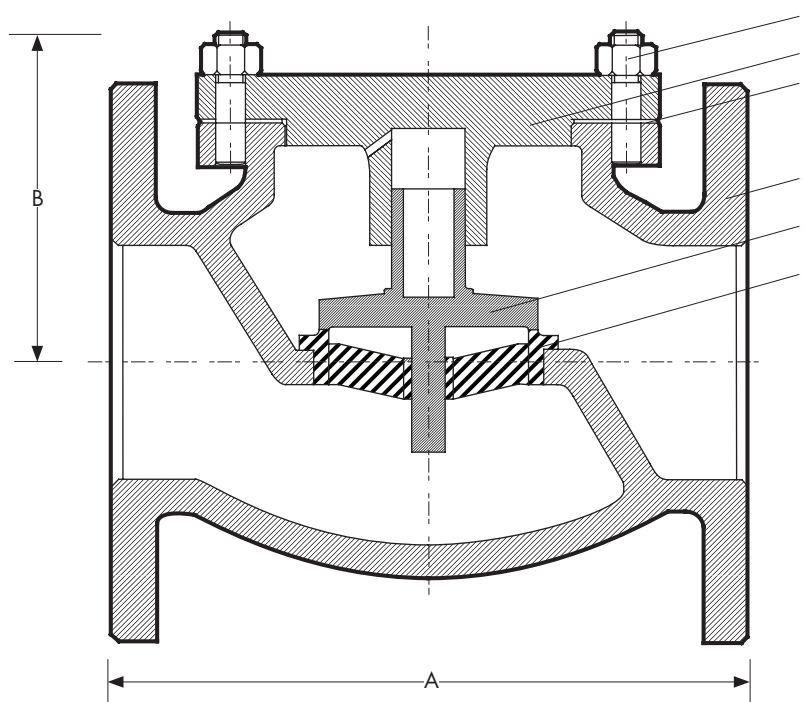

DIMENSIONS - mm										MATERIAL SPECIFICATIONS			
Size	25	32	40	50	65	80	100	125	150	REF	Component	Material	AS or BS Specification
A	162	181	187	216	235	267	330	381	432	1	Fasteners	Stainless Steel	316 S/S
B	84	86	94	96	116	121	163	204	222	2	Cover	Cast Bronze LG2	AS 1565-C83600
Mass kg	6.4	8.4	9.2	11.2	15.6	21.5	38	65	94	3	Gasket	Klinger	K'Sil 4430
<i>Dimensions for larger sizes are available on request.</i>										4	Body	Cast Bronze LG2	AS 1565-C83600
										5	Disc	Cast Bronze LG2	AS 1565-C83600
										6	Seat	Cast Bronze LG2	AS 1565-C83600