



PROMET VALVES AUSTRALIA

1A Green Road Woodville West SA 5011
 www.prometvalves.com promet@prometvalves.com
 T: 08 8268 1777 ABN 47096 425 697 F: 08 8268 1711

Wafer Check Valve 'Dual Disc' ANSI 150 (Viton Seat)



Materials	
PART	MATERIAL
Body	WCB
Seat	Viton
Disc	304 Stainless Steel

Specifications	
Flange	ANSI B16.5
Cold Working Pressure	1965kPa
MAX Working Temperature	150°C

Applications - Water, Oil, Gas, High Pressure Liquids

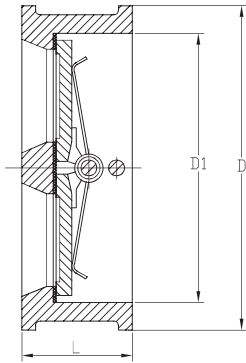

Wafer Check Valve 'Dual Disc' ANSI 150 (Viton Seat)					
CODE	IMPERIAL SIZE	D	D1	L	APPROX. KG/PC
VWCCS15050	2	103	65	42	1.5
VWCCS15080	3	134	95	64	3.5
VWCCS15094	4	164	118	64	4.8