

## Stainless Steel Ball Valves - Maxiflo

MATERIAL LIST	
PART	MATERIAL
Body	CF8M
Ball	316 Stainless Steel
Seat	Teflon (PTFE)
Stem	316 Stainless Steel
Lever	316 Stainless Steel with Locking Device

SPECIFICATIONS	
Thread	AS1722.1
Max Working Temperature	180°C
Cold Working Pressure	6895kPa

Applications - For air, water, Hot/Cold corrosive fluids in harsh environments

## Stainless Steel Ball Valve (1 PCE)

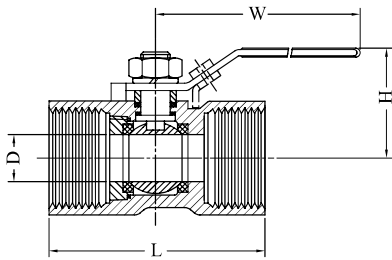

Stainless Steel Ball Valve (1 PCE Reducing Bore)							
CODE	IMPERIAL SIZE	L	H	W	D	TORQUE INCH/LBS	APPROX. KG/PC
SS1BV08	1/4	40	33	67	5	12	0.06
SS1BV10	3/8	45	36	67	7	12	0.1
SS1BV15	1/2	58	37	93	9	12	0.16
SS1BV20	3/4	60	42	93	12.5	18	0.26
SS1BV25	1	71	52	103	16	36	0.38
SS1BV32	1 1/4	78	56	103	20	54	0.61
SS1BV40	1 1/2	82.5	65	125	25	72	0.85
SS1BV50	2	100	70	125	32	84	1.4